



INDUSTRIAL FLEX SPACE



WORLD PARK BUILDINGS 5

10166 International Blvd.
West Chester Twp, OH

FOR LEASE

PROPERTY HIGHLIGHTS

3,820 SF Available

±1,850 SF Office

(1) Drive-in Door (10'x10')

14' Clear Height

Close to many area amenities

Located in West Chester Township, just 20 miles north of downtown Cincinnati

No Local Income Tax

Newly Renovated!

SEATTLE STEIN

Director
+1 513 763 3027
seattle.stein@cushwake.com

TOM MCCORMICK

Managing Director
+1 513 763 3025
tom.mccormick@cushwake.com



201 E. Fourth Street, Ste 1800
Cincinnati, OH
Main +1 513 421 4884
cushmanwakefield.com

WORLD PARK BUILDING 5

10166 International Blvd,
West Chester Twp, OH 45069



BUILDING SPECIFICATIONS

LOCATION	West Chester Twp, OH Butler County
BUILDING SIZE	59,690 SF Total
AVAILABLE SIZE	3,820 SF Available
OFFICE SIZE	±1,859 SF Available
ZONING	M-1 Light Industrial
YEAR BUILT	1987
CONSTRUCTION	CMU
ROOF	Membrane
FLOOR	6" Concrete
CLEAR HEIGHT	14'
TRUCK DOCKS/DOORS	(1) Drive-in Door (10'x10')
TRUCK COURT	Rear Loaded 130' Truck Court
AUTO PARKING	100+ Parking Spaces

FIRE SUPPRESSION	Wet System
LIGHTING	T8 Fixtures
HVAC	Fully A/C
ELECTRIC	TBD
UTILITIES	
ELECTRIC/GAS	www.duke-energy.com
WATER/SEWER	www.butlercountyohio.org
TELEPHONE	www.cincinnatiatibell.com
DATA	www.spectrum.com
LEASE RATE	Undisclosed
OPERATING EXPENSES	\$3.18/psf

CLICK HERE TO VIEW
SITE ON **GOOGLE MAPS**



WORLD PARK BUILDING 5

10166 International Blvd,
West Chester Twp, OH 45069



BUILDING SPECIFICATIONS - SUITE 10166

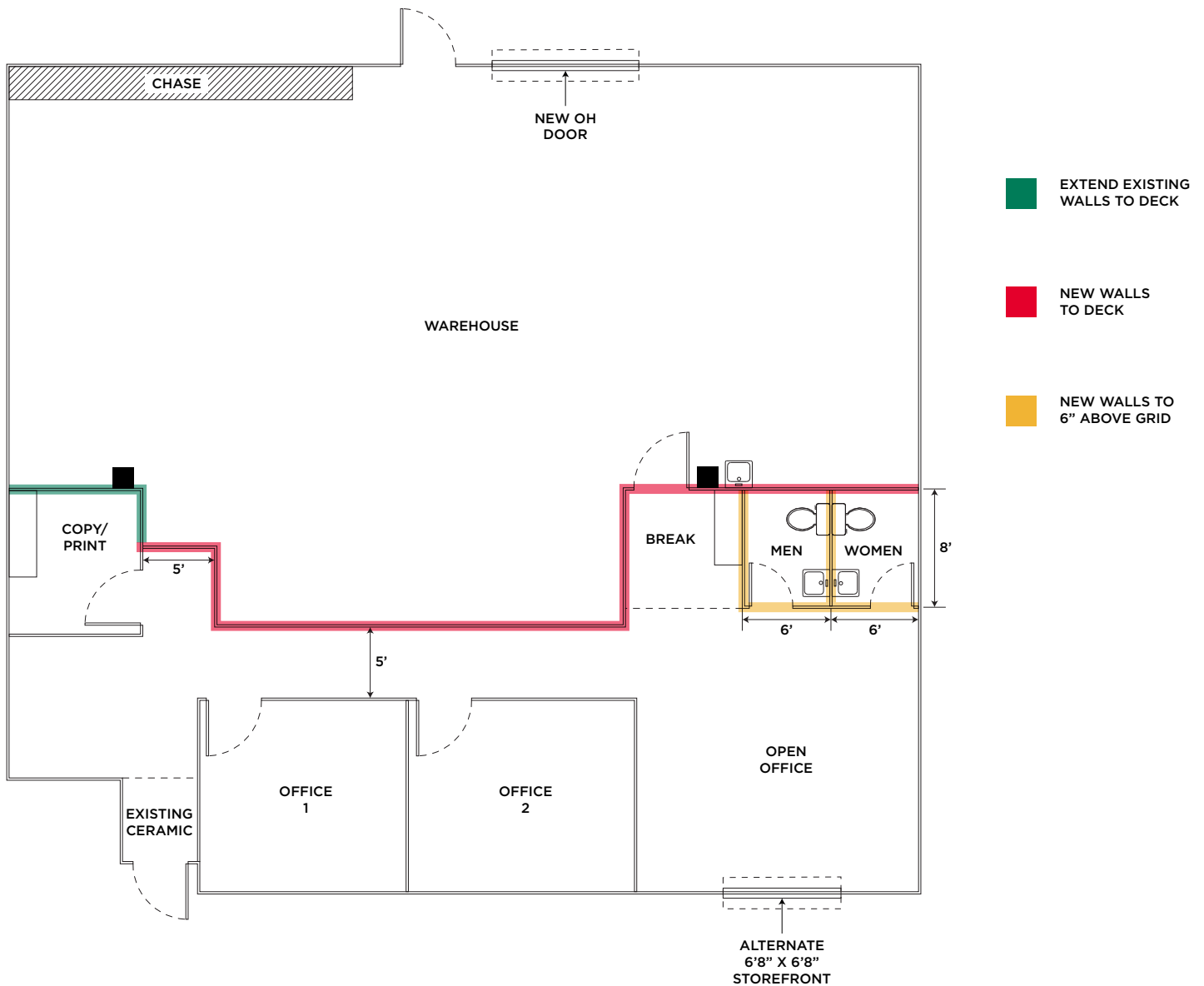

WORLD PARK BUILDING 5

10166 International Blvd,
West Chester Twp, OH 45069



PHOTOS



WORLD PARK BUILDING 5

10166 International Blvd,
West Chester Twp, OH 45069



AVAILABLE SPACE



Address	Space SF	Warehouse SF	Office SF	Doors	Lease Rate
10166 International	3,820 SF	±1,970 SF	±1,850 SF	(1) Drive-in Door	Undisclosed

WORLD PARK BUILDING 5

10166 International Blvd,
West Chester Twp, OH 45069



AERIAL LOCATION

