

# 40-68 LIBERTY INDUSTRIAL PKWY, SUITE 48, MCDONOUGH, GA 30253



**STRATEGIC**  
REAL ESTATE PARTNERS, LLC

## AVAILABLE:

5,600 SF

## USES:

Industrial

## MISC:

Located in McDonough just minutes from I-75, suite 48 of this industrial building is composed of 5,600 SF with +/- 1,400 SF dedicated to office space. Features include open office areas, two (2) bathrooms, one (1) break room, one (1) heater, two (2) dock-high doors, and ample parking.

## PROPERTY INFO:

- Total building: 73,461 SF
- Suite 48: 5,600 total SF
- +/- 1,400 SF office
- Two (2) bathrooms
- One (1) break room
- One (1) heater in warehouse
- Sprinklered
- Two (2) dock high doors
- 26' clear height
- Columns: 40'w x 50'd
- Parking ratio: 1.60/1,000 SF
- Truck court: 115'

**Harrison Gaylord**

770.324.6320

[hgaylord@strategicrepartners.com](mailto:hgaylord@strategicrepartners.com)

[www.strategicrepartners.com](http://www.strategicrepartners.com)

**JR Wright**

404.836.4841

[jrwright@strategicrepartners.com](mailto:jrwright@strategicrepartners.com)

[www.strategicrepartners.com](http://www.strategicrepartners.com)

INDUSTRIAL SPACE FOR LEASE



# 40-68 LIBERTY INDUSTRIAL PKWY, SUITE 48

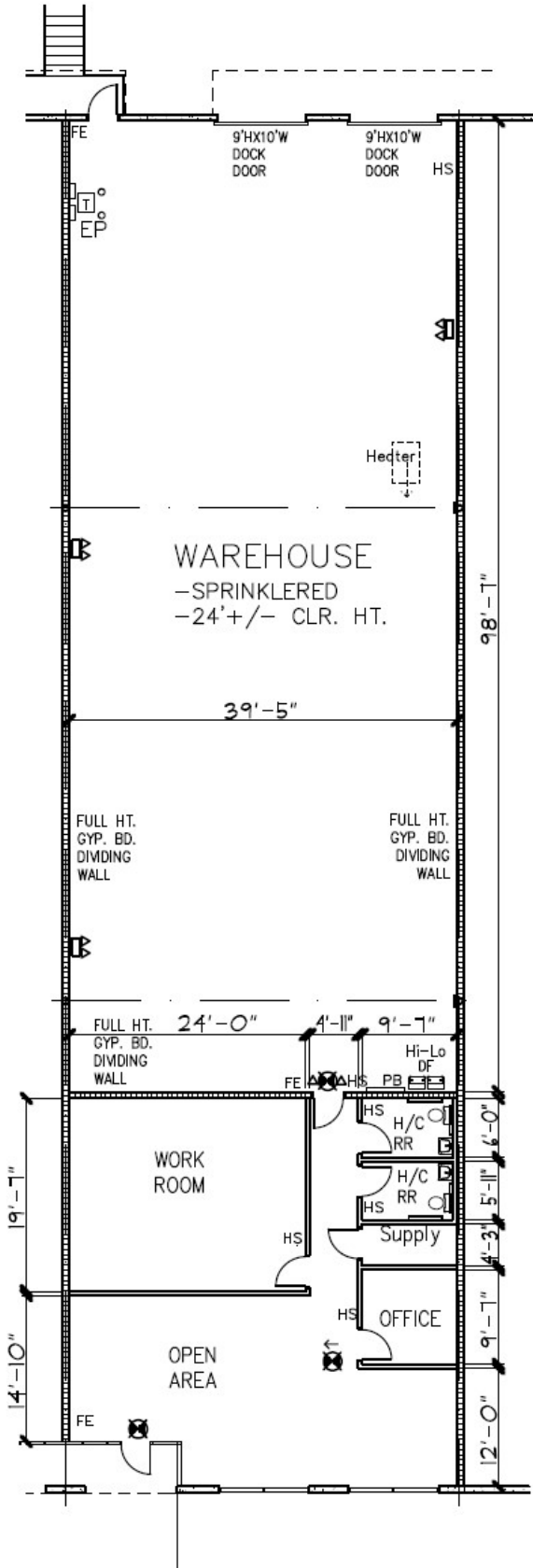

48

## LIBERTY INDUSTRIAL PARKWAY

McDonough, GA 30253

SQUARE FOOTAGE	
TOTAL	5,600

KEY PLAN



46 48

# 40-68 LIBERTY INDUSTRIAL PKWY, SUITE 48





**STRATEGIC**  
REAL ESTATE PARTNERS, LLC

# 40-68 LIBERTY INDUSTRIAL PKWY, SUITE 48

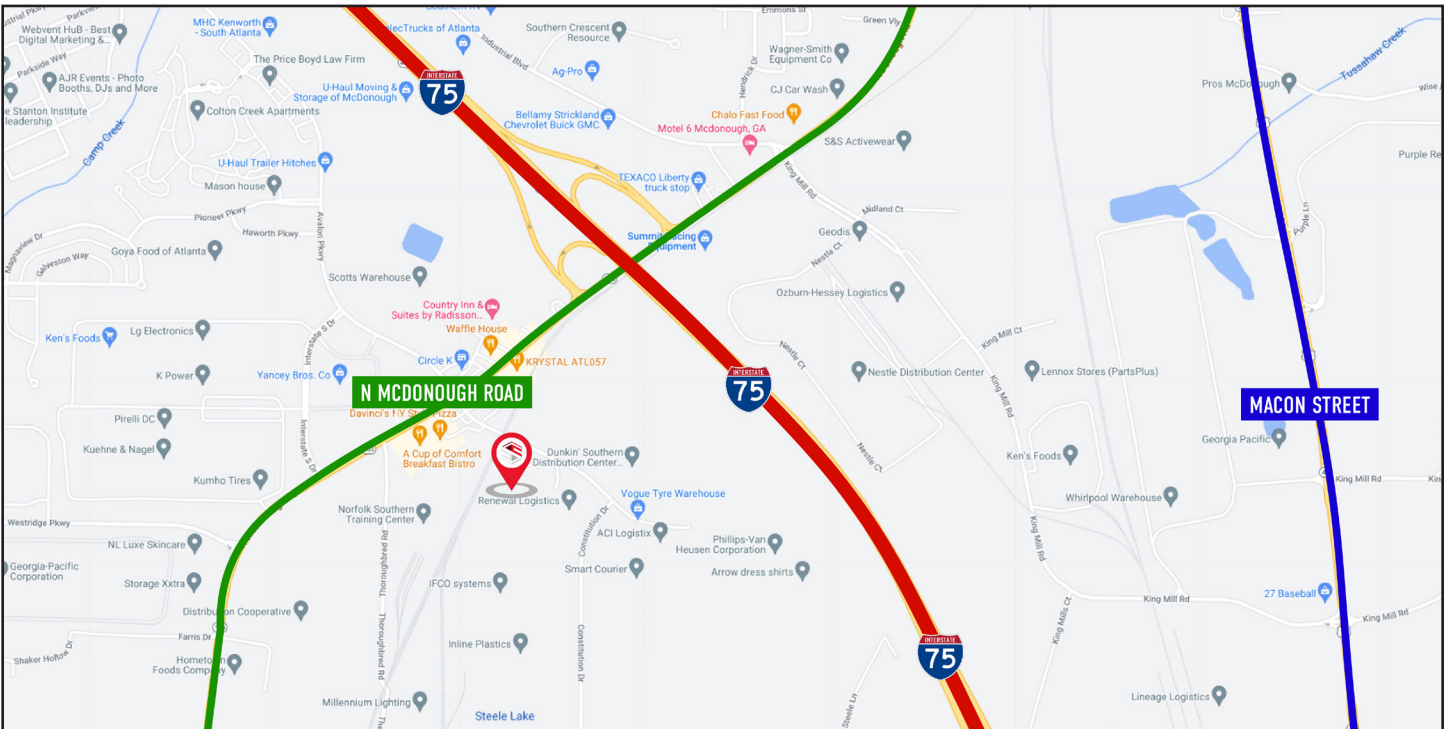
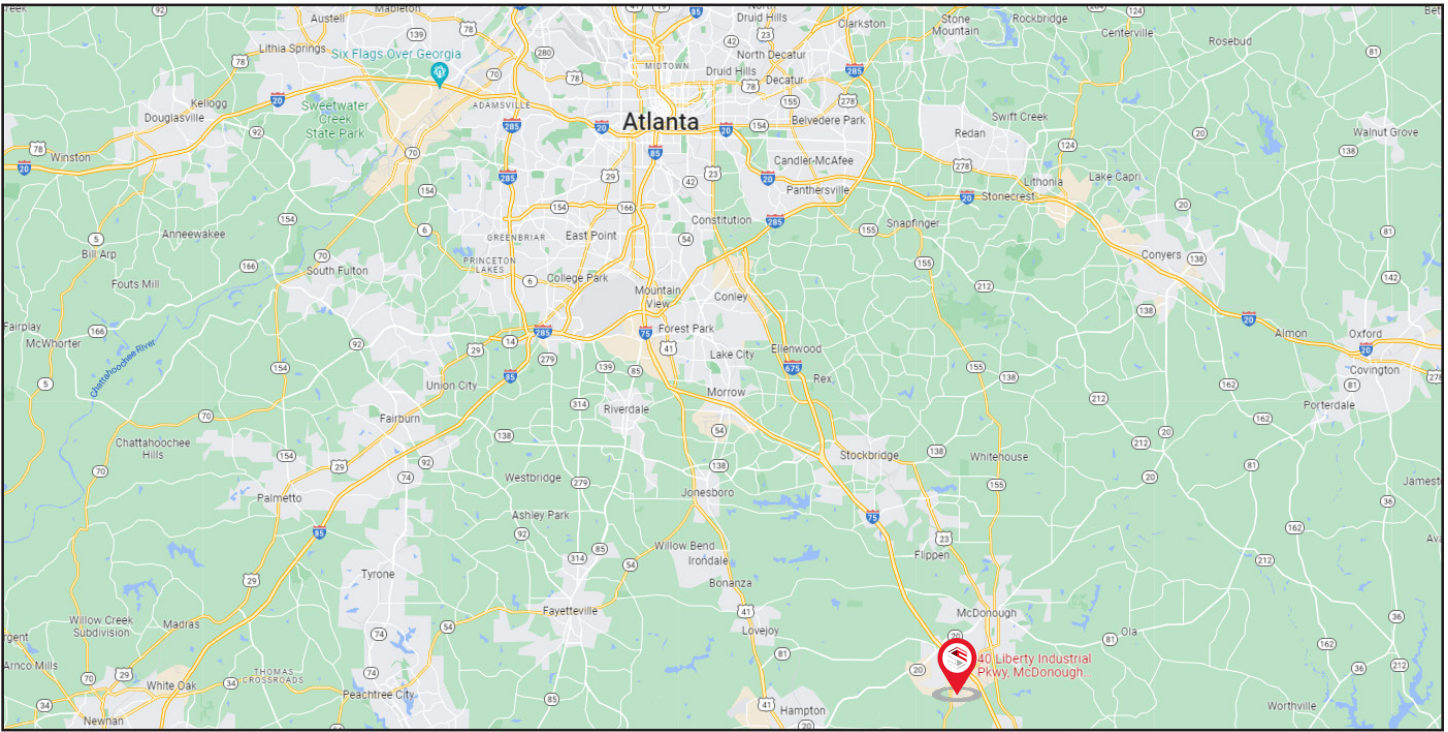

**Harrison Gaylord**

770.324.6320

hgaylord@strategicrepartners.com

www.strategicrepartners.com

**JR Wright**

404.836.4841

jrwright@strategicrepartners.com

www.strategicrepartners.com