

West Valley Logistics Center

±139,060 SF (divisible) for lease
12000 North 132nd Avenue
Surprise, Arizona



Jones Lang LaSalle Americas, Inc.
License #: C0508577000



**±2,821 spec office
suite complete**

±2,821 spec office suite complete

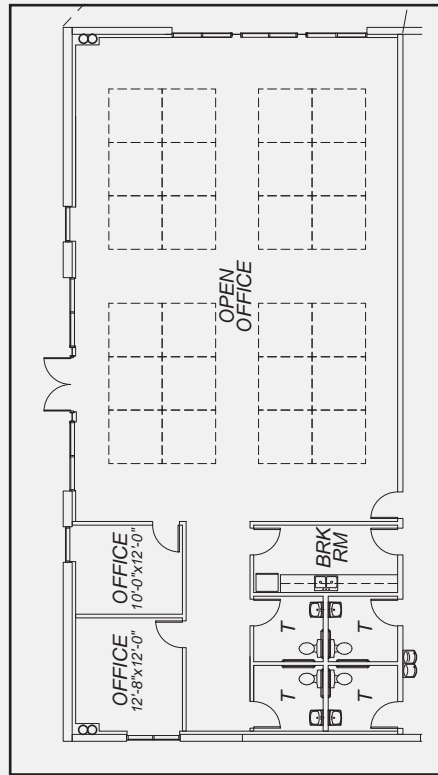

Property features

- ±418,651 SF total building size
- ±139,060 SF available (divisible)
- ±2,821 spec office suite complete
- 32' clear height
- Typical column spacing: 52' x 52'
- 27 dock high doors; 2 ramp to grade doors
- Power: 2,200A, 277/480V, expandable (APS)
- Existing fiber to building (Cox & CenturyLink)
- Roof system: Steel truss structure; TPO roof membrane with R-30 insulation
- Evaporative cooled warehouse
- LED lighting throughout
- ESFR sprinklers
- Floor: 6" concrete reinforced slab
- 4' x 8' skylights
- Full concrete truck courts
- Truck court depth: ±180'
- 46 trailer parking spaces
- IP zoning, City of Surprise
- ±2.5 miles from Northern Parkway
- ±4 miles from Loop 303 via full diamond interchange at Cactus Road



30 minute drive demographics



Total population: 1,468,272; projected to grow to 1,584,001 by 2023



Population by generation

- Millennial: 26%
- Generation X: 19%
- Baby boomer: 19%
- Greatest generation: 8%



Population by education level

- Associate: 8.5%
- Bachelor's: 14.9%
- Graduate: 7.8%

West Valley Logistics Center

is minutes from the confluence of Interstate 10 and Arizona Loop 303, ideally located to serve Arizona as well as the key markets in the Western United States including San Francisco, Ports of Los Angeles/Long Beach, New Mexico, Utah, Nevada, and Southern California's 23 million population.

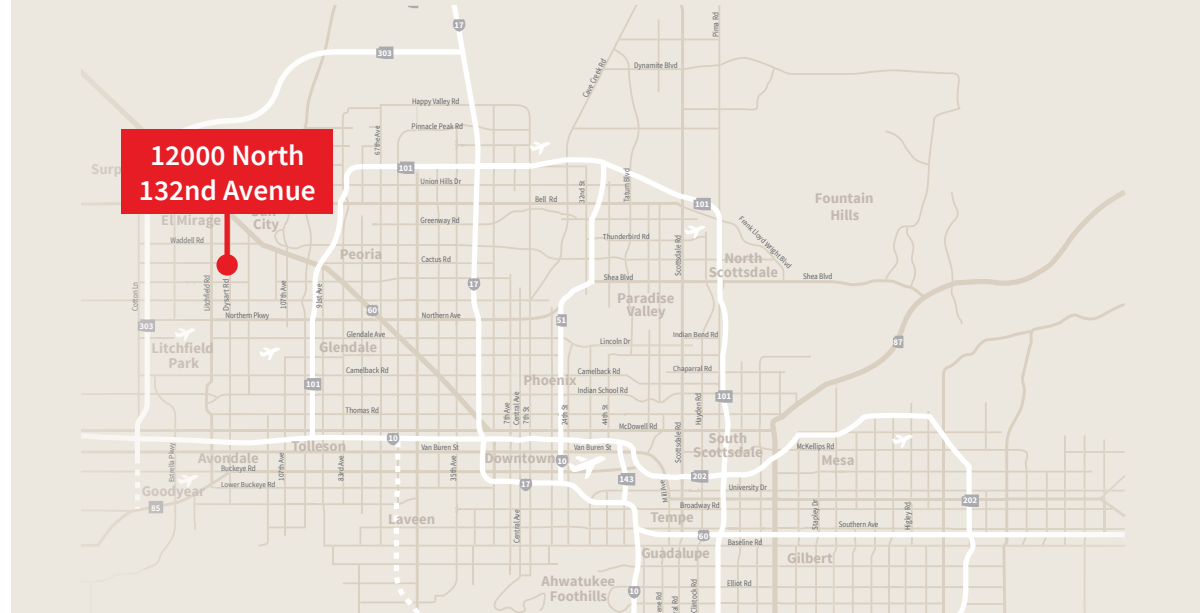



For additional information:

Riley A. Gilbert
Executive Vice President
+1 602 282 6271
riley.gilbert@jll.com

John Lydon
Senior Vice President
+1 602 282 6326
john.lydon@jll.com

Bill Honsaker
Managing Director
+1 602 282 6267
bill.honsaker@jll.com

Anthony J. Lydon, CSCMP
Senior Managing Director
+1 602 282 6268
aj.lydon@jll.com

jll.com/phoenix
+1 602 282 6300

[@jllphoenix](https://twitter.com/jllphoenix)
[jllblog.com/phoenix](https://www.jllblog.com/phoenix)

Dalfen
INDUSTRIAL



Although information has been obtained from sources deemed reliable, neither Owner nor JLL makes any guarantees, warranties or representations, express or implied, as to the completeness or accuracy as to the information contained herein. Any projections, opinions, assumptions or estimates used are for example only. There may be differences between projected and actual results, and those differences may be material. The Property may be withdrawn without notice. Neither Owner nor JLL accepts any liability for any loss or damage suffered by any party resulting from reliance on this information. If the recipient of this information has signed a confidentiality agreement regarding this matter, this information is subject to the terms of that agreement. ©2021 Jones Lang LaSalle IP, Inc. All rights reserved.